

SRAM

TECHNICAL

DOCUMENTATION

SPECTRO S7

NO 0368 001 020

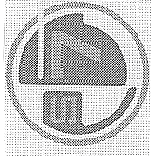
SRAM

Operation

GEAR CHANGING

- Keep pedaling without effort as you change gears.
- Should the desired gear not engage immediately, stop pedaling for a short moment.
- Change gears in time before going uphill.

Assembly

Caution:

The Spectro S7 hubs are not suitable for tandems, trademen's delivery bicycles and similar.

ASSEMBLY SHIFTER AND CLICKBOX

- Slide shifter (1, Fig. 5) onto handlebar.
- Mount fixed grip (2) onto end of handlebar.
- Slide shifter against fixed grip, adjust shifter on handlebar and tighten with bolt (3) with a torque of 1.5 Nm (13 in. lbs.).

Caution:

- Check that the shifter and brake lever function properly and are unobstructed (realign if necessary).

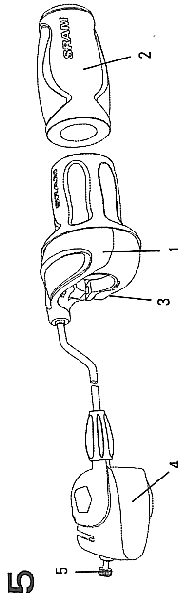

- Fixed grips provide an axial safety function. For this reason, they should be mounted in such a way as to make sure they do not slip off handlebar.
- Never use lubricants or solvents to install fixed grips.
- Never ride without the fixed grips. The turning grip may loosen from housing and slip off handlebar — this can result in severe injury or death.

- When fitting the cable avoid small radius. Attach the cable to the down tube.

Yellow Jersey

In the heart of downtown Madison

419 State St

Madison, WI

324 W Gorham St

Madison WI

608. 257. 4737

53703. 2027

608. 257. 7733

53703. 2017

| M | T | W | R | F | S | S |
|-------|-------|-------|-------|-------|------|-------|
| 10:00 | 10:00 | 10:00 | 10:00 | 10:00 | 9:00 | 12:00 |
| 8:00 | 6:00 | 6:00 | 8:00 | 6:00 | 5:00 | 5:00 |

HOLIDAY HOURS Noon to 5 pm

FAX 608. 257. 5161

Yellow Jersey
virtually wherever you are!
www.yellowjersey.org



Removing / Refitting rear wheel

REMOVAL

- Place the rotational shifter in gear position „1“.
- Loosen the knurled screw (1, Fig. 1) and pull the clickbox off the axle.
- Disengage the location sleeve (3, Fig. 3) and pull it off.
- Remove shift rod/tube (1/2) out of the axle bore.

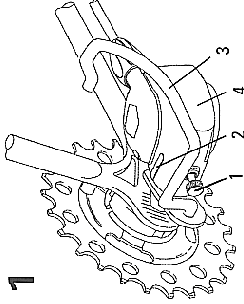

REFITTING

- Fit non-turn washers (4, Fig. 2) on both sides. The serrations must bear against the dropout and the lug must engage in the dropout slot.
- No additional washers or any accessories are permitted on the sprocket side of the axle.
- Fit the guard (3, Fig. 1) on the bracket side
- Tightening torque of the axle nuts about 35 Nm. (310 in. lbs.)

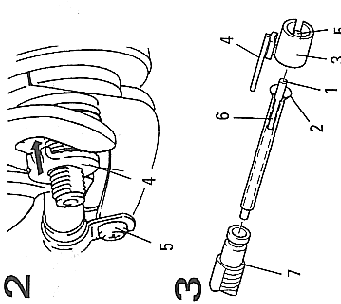

Shift adjustment / Maintenance / Care

SHIFT ADJUSTMENT

Be sure to reset rotational shifter from 5th. to 4th gear. Match up the marks in the Clickbox viewing window by turning the adjusting screw (1, Fig. 6). Check this setting from time to time.

MAINTENANCE / CARE

Caution:

- Brake pads resp. cylinders, brake cables, shifting cables, handlebar grips, sprockets and bicycle chains are wearing parts. Control this parts regularly and replace in time.
- If the coaster brake is loaded excessively its effect can be too strong, the hub may lock. In such a case the brake shell should be lubricated with a special grease (this should be done by a professional only).

6

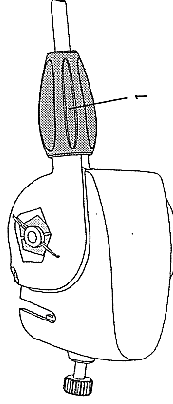

- Do not use high-pressure water when cleaning the gear hub (e.g. strong water jets, high-pressure cleaners etc.) — if water penetrates it could lead to functional problems.
- Do not use solvents or corrosive materials to clean the components.
- When using the bike during the winter more frequent cleaning is necessary to prevent damage caused by de-icing salt.
- Clean dirty chains before oiling. Do not use any grease-dissolving or acidic agents. Cleaning agent must be rinsed off after a few minutes with water. Apply oil after chain is completely dried.